

SENSENICH PROPELLER CO., INC.

AREA CODE 813
PHONE - 752-3711
FAX - 752-2818



2008 WOOD COURT
PLANT CITY, FL USA
33563

ADDENDUM TO HUB MODEL 3Y0R5 INSTALLATION INSTRUCTIONS

***Only applicable to hub serial numbers between: 321849C – 321908C**

Early model 3Y0R5 3 blade hubs can possibly wear between the hub barrels and spinner rear bulkhead. Hub shim A-1879 placed between hub mount and spinner rear bulkhead provides clearance and eliminates potential wear.

This addendum supplements the current installation instructions for hub model 3Y0R5. Standard hardware kit can be used with hub shim A-1879.

PACKING LIST FOR 3Y0R5 WITH A-1879 HUB SHIM

ITEM	DESCRIPTION	QTY
1	M8 X 1.25 X 40 SHCS Clamping Bolts	6
2	M8 X 1.25 SHCS Mounting Bolts	6
3	NL8 sp Nord-Lock Washers	12
4	3Y0R5 Hub Cover Half	1

ITEM	DESCRIPTION	QTY
5	Composite Propeller Blade	3
6	3Y0R5 Hub Mount Half	1
7	A-1879 Hub Shim	1
8	Rear Spinner Bulkhead	1

*Flange bushing style may vary by installation type.

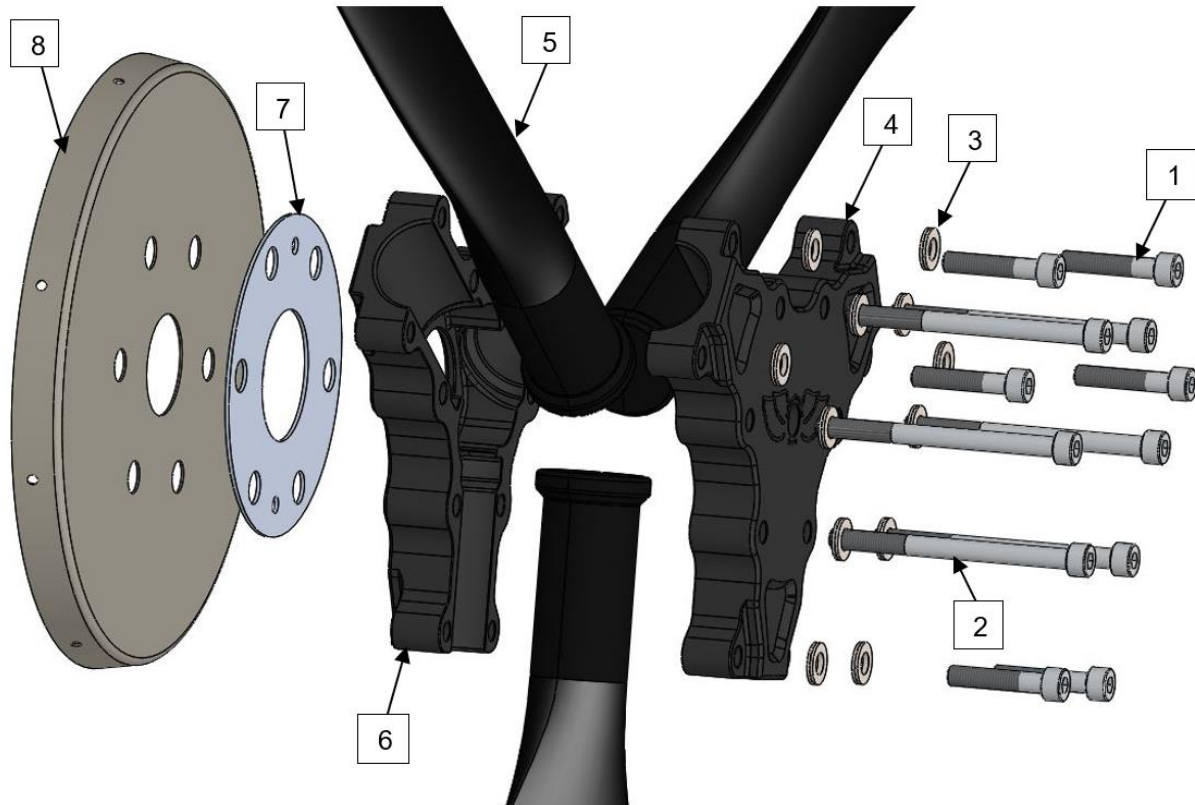

Figure 1: Propeller Assembly with A-1879 Hub Shim

Replace steps 1 & 2 in the 3Y0R5 Installation Instructions with the following:

1. *Ensure the aircraft magneto switch is in the "Off" position and the both magnetos are grounded any time the propeller is handled.* Chock the aircraft wheels to prevent movement. Clean dirt and oil residue from the engine flange. Refer to **Figure 1.** for views of the two piece hub, hub shim, and blade.
2. Place spacer (if required) and rear spinner bulkhead on the propeller mounting flange. The A-1879 Hub Shim is next installed between the rear spinner bulkhead and hub mount. See **Figure 1.**

Complete the remaining propeller installation procedure using the 3Y0R5 Installation Manual starting at step 3.